

STEP 1

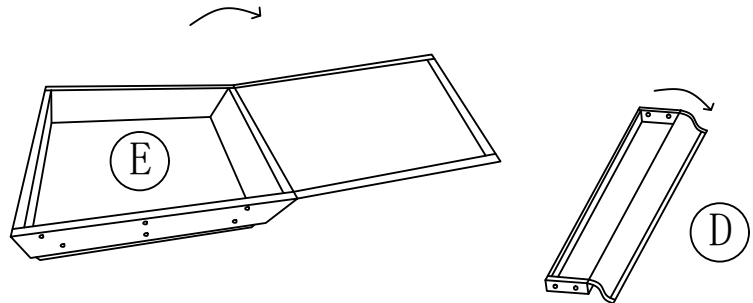

1. Tear off the Velcro

STEP 2

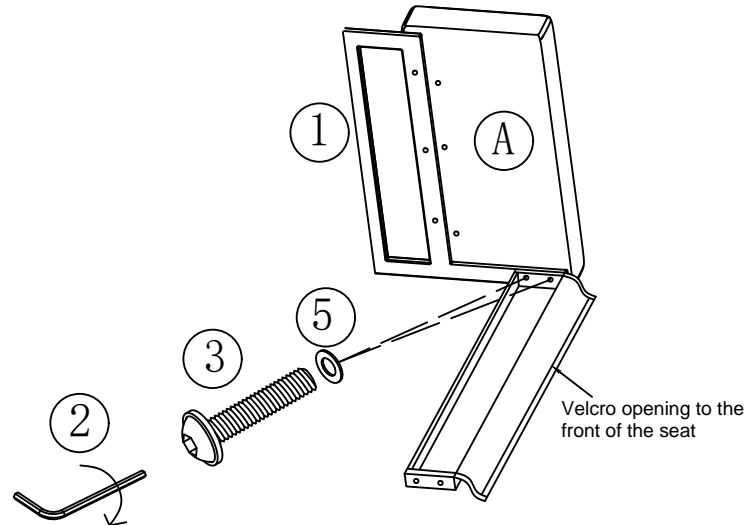

1. Secure the backrest, metal base and right armrest with pan head socket screw with washer M6*60. Repeat the same for the left armrest.

STEP 3

1. Use Cup head hexagon screw M6*80 to fix the back rest, iron leg and right armrest.

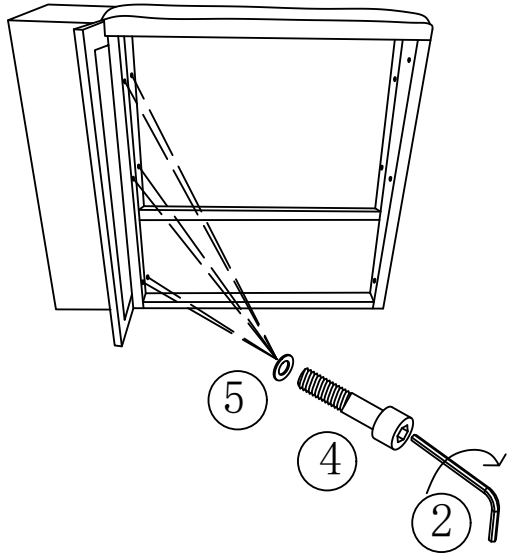

STEP 4

1. Use Cup head hexagon screw M6*80 to fix the back rest, iron leg and right armrest.

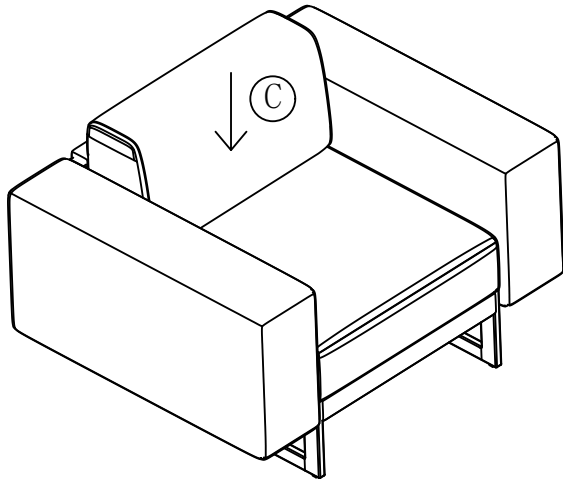
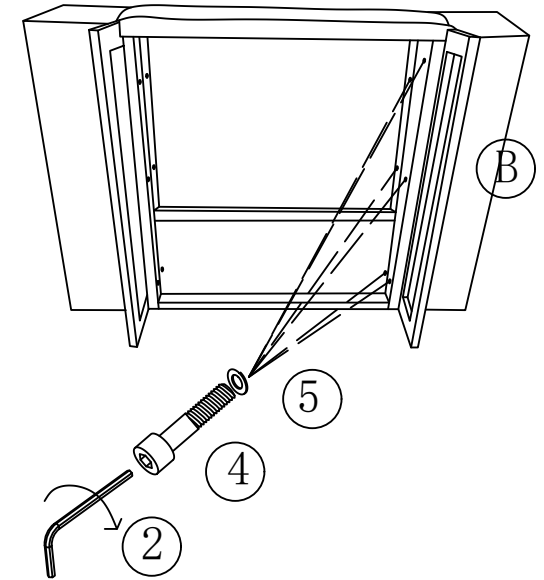

1. put the back cushion on the seat

STEP 5

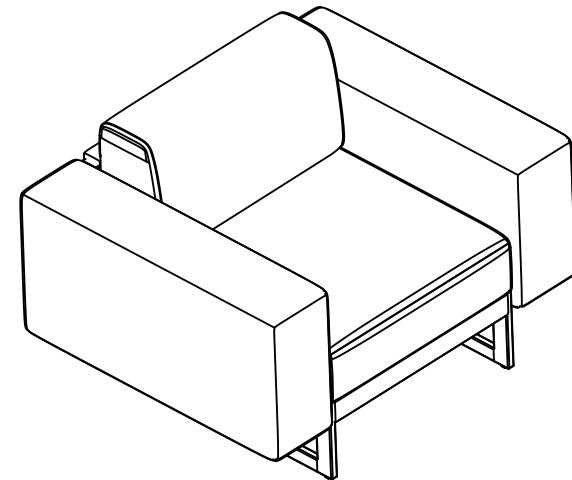

STEP 6